

RAW WATER STRAINERS (BISO)



All Arctic Steel water strainers are cast with 2205 stainless steel. This provides an exceptional level of corrosion resistance. Additionally our strainers undergo an electro polishing process which removes contaminants from the surface exposing the pure stainless steel, providing a rich chromium film, as is evident by the shine to our stainless steel. This gives our already robust strainers a defence against corrosion superior to others on the market.

Bottom In Side Out Range

- Electro-polished AISI 2205 cast stainless steel body.
- Solid electro-polished stainless steel lid.
- Secured by 5 wing nuts for safe, quick and easy access. No tools required.
- Swing down eye bolts eliminates need to remove nuts.
- BSP or NPT thread available.
- Full height, high impact resistant ABS basket.
- Cast anode connection point to combat galvanic corrosion.

Available Options:

- Interchangeable clear, poly carbonate lid.
- 316 Stainless Steel basket.
- 316 Stainless Steel side mounting brackets and extension arms.

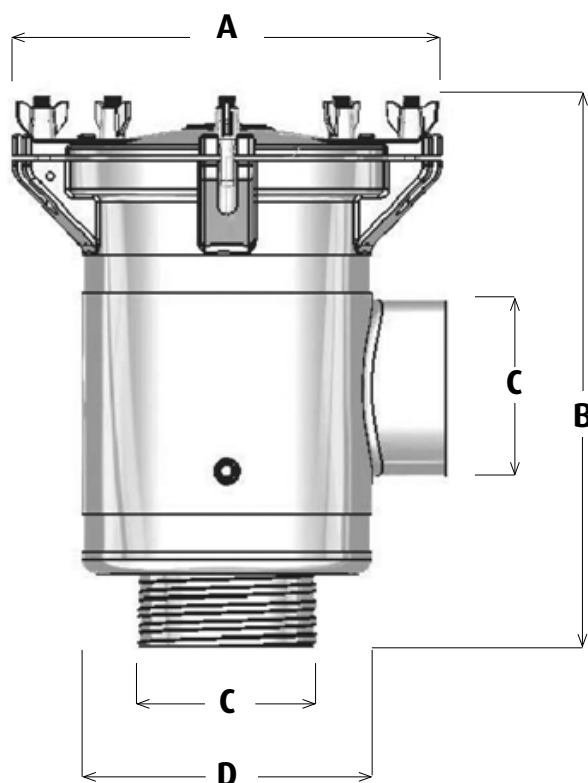

Size Inlet Thread / Outlet Thread	Weight Kg Solid	Flow Rate 0.1 Bar L/Min	Flow Rate 1 Bar L/Min	Lid Width A mm	Height B mm	Thread Size C mm	Body Width D mm
1" M/F	3.1	138	431	141	212	1" /25mm	95
1.5" M/F	3.2	324	1030	141	212	1.5" /38mm	95
2" M/F	6.1	485	1615	200	272	2" /50mm	140
2.5" F/F	6.2	640	2154	200	272	2.5" /63mm	140
3" F/F	12.5	973	2998	235	332	3" /75mm	164
4" F/F	18.5	1845	5850	273	474	4" /100mm	220
6" F/F	30.5	3184	10289	360	510	4" /150mm	310

Flow rates calculated using clean ABS basket



GENERAL
Marine
SERVICES

156 Beaumont Street • Westhaven • Auckland • New Zealand

Sales Ph +64 9 309 0048 • sales@generalmarine.co.nz

Service Ph +64 9 368 0938 • service@generalmarine.co.nz

www.generalmarine.co.nz