



APOLLO® SEA FLANGE VALVES



FULL FLOW

An 85-5-5 bronze ball type valve developed to replace plug and other types of sea cocks in the boating industry. Features like these make the full flow Apollo® Sea Flange your best choice for long-lasting performance and value.

FEATURES

- UL Listed
- All AYBA Recommended Materials
- All Bronze Wetted Metallic Components
- Large Flow Ports (Designated by "F" at the End of the Part #)**
- RPTFE Seats and Seals
- Chromium Plated Bronze Ball—Resists Damage from Marine Growth
- Easy On-Off Operation
- Winterizing Drain Plug
- No Thumb Screws to Create Seal
- Stainless Steel Lever and Nut
- Compact, Streamlined Efficient Design
- No Lubrication Required
- Bonding Screw Standard

DIMENSIONS

PART NUMBER	SIZE	DIMENSIONS (IN.)								WT. (LB.)
		A	B	C	D	E	F	G	H	
78-115-01F**	3/4"	0.75	1.56	3.62	2.16	4.78	0.34	3.12	0.06	2.70
78-118-01	1"	1.00	1.87	4.25	2.62	5.50	0.34	3.37	0.25	3.80
78-119-01	1-1/4"	1.25	2.15	4.81	2.81	5.50	0.34	3.62	0.37	5.75
78-116-01F**	1-1/2"	1.50	2.37	5.21	3.13	5.37	0.34	4.50	0.34	7.25
78-120-01	2"	2.00	2.84	6.25	4.68	8.00	0.34	5.00	0.87	12.90
78-117-01	2-1/2"	2.50	3.18	6.87	4.00	8.00	0.34	5.87	1.00	18.20
78-121-01A	3"	3.12	3.54	7.23	5.21	9.93	0.40	7.00	1.25	21.18
78-122-01A	4"	4.00	3.75	8.06	5.68	9.93	1.13	8.44	1.90	33.05

Contact Customer Service for availability on locking handle option

** Large flow ports

COMPONENTS

1	Lever & Grip
2	Gland Screw
3	Stem Seals
4	Body Seal, Except 3"- 4"
5	Retainer
6	Ball
7	Seat (2)
8	Stem
9	Body
10	Lever Nut
11	Plug

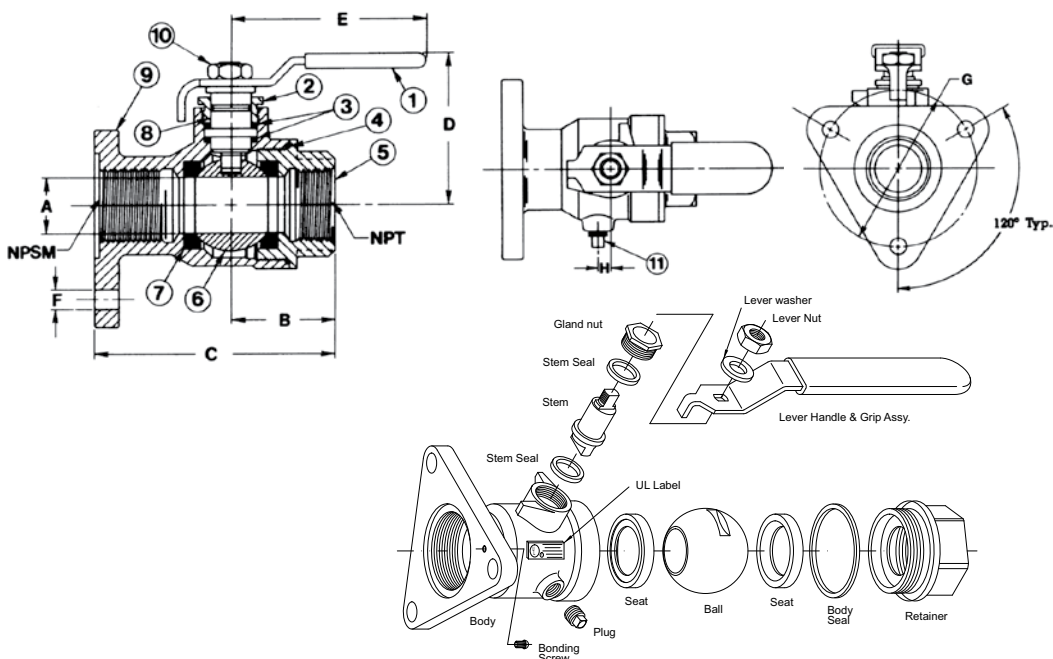

ECONOMY

Same great features and quality all-bronze construction as Full Flow Sea Flange valves, but with standard port design and lower cost.

DIMENSIONS

PART NUMBER	SIZE	DIMENSIONS (IN.)								WT. (LB.)
		A	B	C	D	E	F	G	H	
78-115-01	3/4"	0.68	1.50	3.50	2.18	4.87	0.34	3.12	0.06	2.32
78-116-01	1-1/2"	1.25	2.18	4.81	2.87	5.50	0.34	4.50	0.18	6.30

Contact Customer Service for availability on locking handle option

NOTE: Apollo® Marine Valves used in applications where marine growth can become intrusive should be actuated to the fully closed and fully open positions as often as once per month and at minimum once every other month. Such cycling of these valves can reduce the effort needed to open and close the valves while also helping to clear marine growth buildup on components.

